

PRIMEX

Product Specifications

P700FCC-XHG1SA

1 Fiber Cross-Connect OSP Enclosure

1. SUMMARY

The Primex Wave P700FCC-XHG2SA is a compact one fiber cross-connect enclosure ideal for FTTH SFU or small business retrofit brownfield applications.

The simplex SC/APC adapter and integrated cable management allow for the quick connection and storage in dual fiber applications.

2. PRODUCT DIMENSIONS

Inside: H 7.6"/W 6.1"/D 2.5"
Outside: H 10.2"/W 8.9"/D 3.3"

3. FEATURES & BENEFITS

- Small footprint, low profile design with back access port for fitting over existing entry points.
- Integrated fiber management and an SC/APC adapter for easy single fiber implementation.
- Snap lock and hex bolt provide secure service provider access 24/7.
- High quality UV-protected PVC made in North America for long-lasting fiber protection in demanding weather conditions.
- Two robust one-inch ports with grommets for protected fiber entry and exit.
- External wall and pole mounting brackets allow for quick and easy deployment.
- UL-listed and industry-standardized for easy implementation.

4. APPLICATIONS

- FTTH for single family units
- FTTB for small businesses (MTU)

5. CONFIGURATIONS

Part #	Part Name	Description
125-1690	P700FCC-XHG1SA	Hex, gasket, SC/APC, 2x grommets, 3x HClips, ground lug, 2x fiber cradles

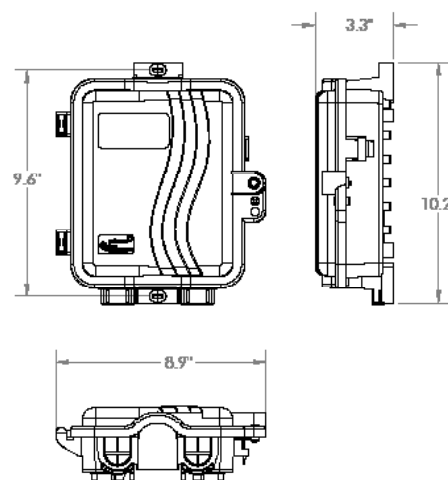
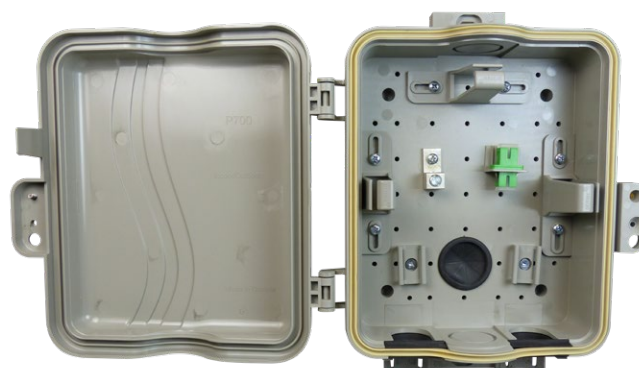

FOR MORE INFORMATION CONTACT:

1.604.881.7875 1.604.881.7835

www.primex.com



primex  Fit everything. Together.