

Please read instructions carefully prior to assembly. Scan QR code below for more product information.

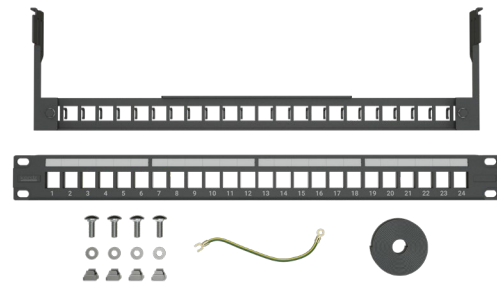

Included Parts



PRO Modular Keystone Patch Panel, 1U 24 port, Shielded, Black

Field assembly instructions for installers

1

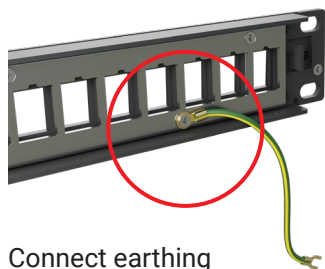

Connect earthing
wire to panel

2

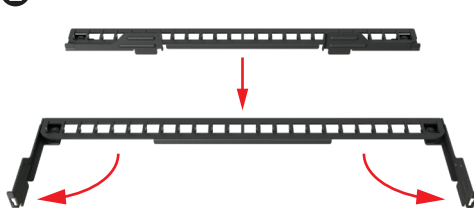

Unfold cable management bar
prior to attaching it to panel

3

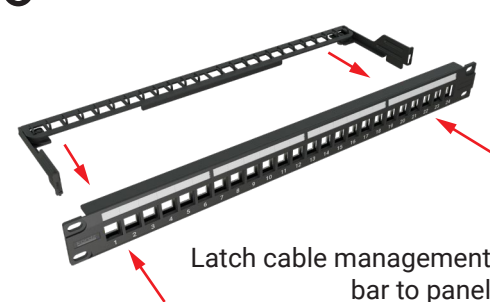

Latch cable management
bar to panel

4

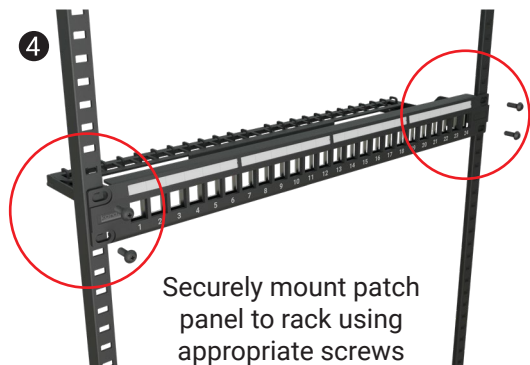

Securely mount patch
panel to rack using
appropriate screws

5

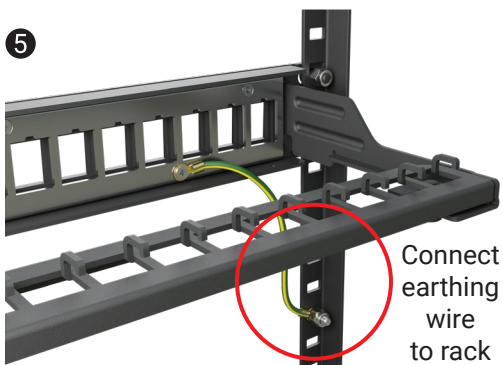

Connect
earthing
wire
to rack

6



Terminate cables into keystones.
Scan the QR code for Kordz keystone
socket installation guides.

7

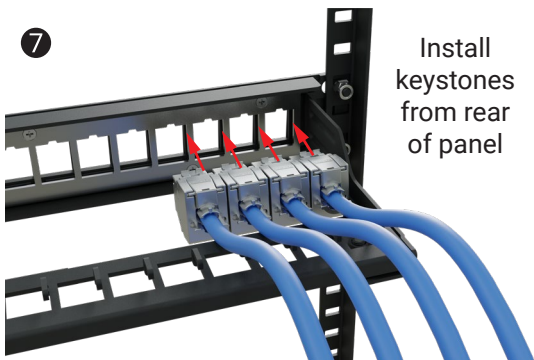

Install
keystones
from rear
of panel

8

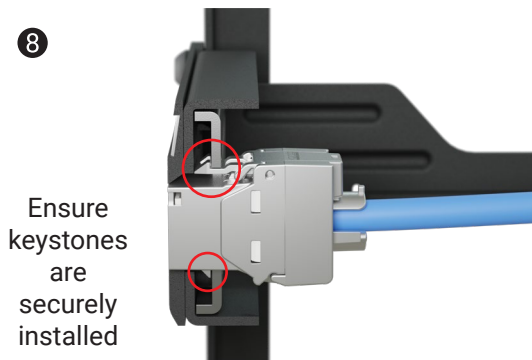

Ensure
keystones
are
securely
installed

9

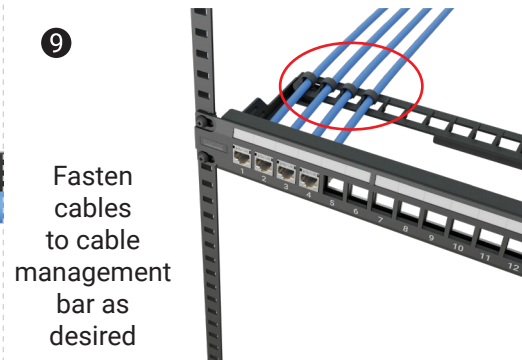

Fasten
cables
to cable
management
bar as
desired